

C A S E S

BATHS

BUDAPEST, ISTANBUL, VALS and ISRAEL.

Present chapter contains the projects, places and bath cultures that serve as inspiration for Industrial bath.

There are four primary bath complex cases:

The Szechenyi Thermal Baths of Budapest from 1913 provided the initial idea of an Industrial Bath and layout of the building.

The Hammams of Istanbul from 1500-1800 - which is visited initially in the design process - has important influence throughout the design process. The simplicity of the spatial programme and decoration leave a powerful impression on this visitor.

Also influential are the Vals Baths from 1996 and the Roman-Byzantine baths excavated in Israel, from 400. These baths are keenly integrated into a hilly landscape. The design of the two baths according to the corners of the world and the landscape is strikingly similar and has provided inspiration for the basic building layout principles of Industrial Bath.

Other important sources of inspiration are underground structures such as the chalk mines of Tingbæk, the sketch project for a Silkeborg museum by Jørn Utzon and the technical underworld of the swimming pool Haraldslund in Aalborg.

Also the plan layout of Chinese temples inspire the project.

Finally, insight on how to excavate and form the ground is found on the site of Portland. Study trips to the chalk excavations have supplied understanding into this logic.

ISTANBUL

STUDY TRIP

Mid February 2008 Turkish bath culture and architecture is studied in Istanbul. It is the hope that this journey to a strong tradition of Hammam baths generate inspiration for Industrial Bath and fresh eye perspective on bath culture in Europe.

The simplicity of the Hammam bath complexes is breathtaking. The most powerful baths consists of just one large hot space, an adjacent smaller cool space and a space for changing cabinets. Daylight enters the spaces through small holes in the domes that crown the spaces.

The life of the Hammam is completely disconnected from the outside buzzing hectic daily life on the street.

The Hammam visitor spends most of his time inside the large bath space on a warm stone for rest and massage. Sometimes he pours himself with water in the small niches of the large space to cool the body or to wash.

HAMMAM DATA

During the visits to the Hammams of Istanbul, quantitative data of temperature and humidity is recorded by small automatic apparatus that measure the temperature minute by minute.

The peaks of heat and coolness in the graph is measured in the hot or cool spaces adjacent to the primary space of the Hammam.

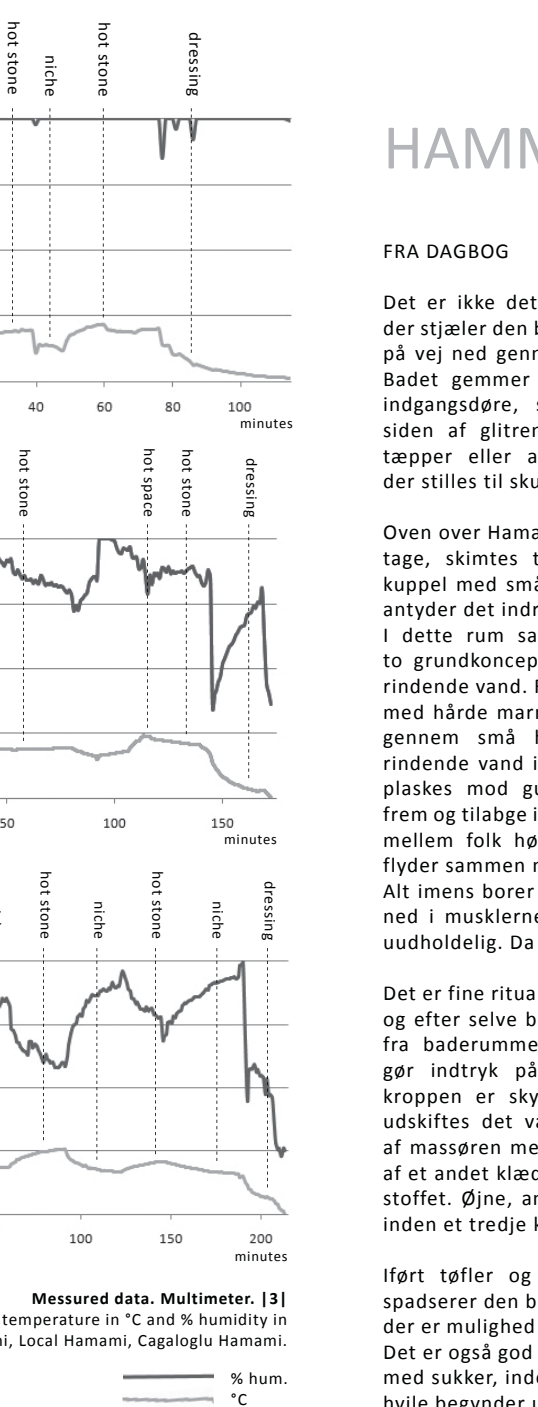

HAMMAM

FRA DAGBOG

Det er ikke det Tyrkiske bad 'Hammamen', der stjæler den besøgendes opmærksomhed, på vej ned gennem Istanbuls snævre gader. Badet gemmer sig af vejen bag anonyme indgangsdøre, som knapt bemærkes ved siden af glitrende guldringe, håndvævede tæpper eller appetitvækkende krydderier, der stilles til skue i oplyste butiksruder.

Oven over Hammamens indgangsdør, på byens tage, skimtes toppen af en kobberbelagt kuppel med små lysuller. Dens runde form antyder det indre baderum.

I dette rum sammenkøbes på fineste vis to grundkoncepter: Det varme rum og det rindende vand. Rummet er stort, opadvendt, med hårde marmoroverflader og kun oplyst gennem små huller i kuplen. Lyden af rindende vand i fontænerne eller vand, der plaskes mod gulvet, forstærkes og kastes frem og tilbage i rummets volumen. Samtaler mellem folk høres som rungende lyd, der flyder sammen med andre lyde.

Alt imens borer massøren sine fingerspidser ned i musklerne, indtil smerten er nærved uudholdelig. Da giver han slip.

Det er fine ritualer, der hører sig til, både før og efter selve badet. Særligt overgangen ud fra baderummet til omklædningsrummene gør indtryk på den besøgende. Efter at kroppen er skyllet ren for sved og sæbe udskiftes det våde lændeklæde behændigt af massøren med et tørt. Skuldrene dækkes af et andet klæde og fastgøres med en fold i stoffet. Øjne, ansigt og hår tørres grundigt, inden et tredje klæde dækker hovedets isse.

Iført tæfler og indpakket som en mumie spærrer den besøgende til sin kabine, hvor der er mulighed for en lur inden påklædning. Det er også god skik at nyde en varm kop the med sukker, inden dagens dont eller nattens hvile begynder udenfor Hammamens døre.



Top: Section. Felt-tip pen.
Atmosphere of secluded courtyard.
Primary space of Hammam with central hot stone.
Bottom: Photo.
A towel around the waist - for women also around the chest - is the dress code before entering the baths. Visitors move through a cool space before entering the visitor's cabin.

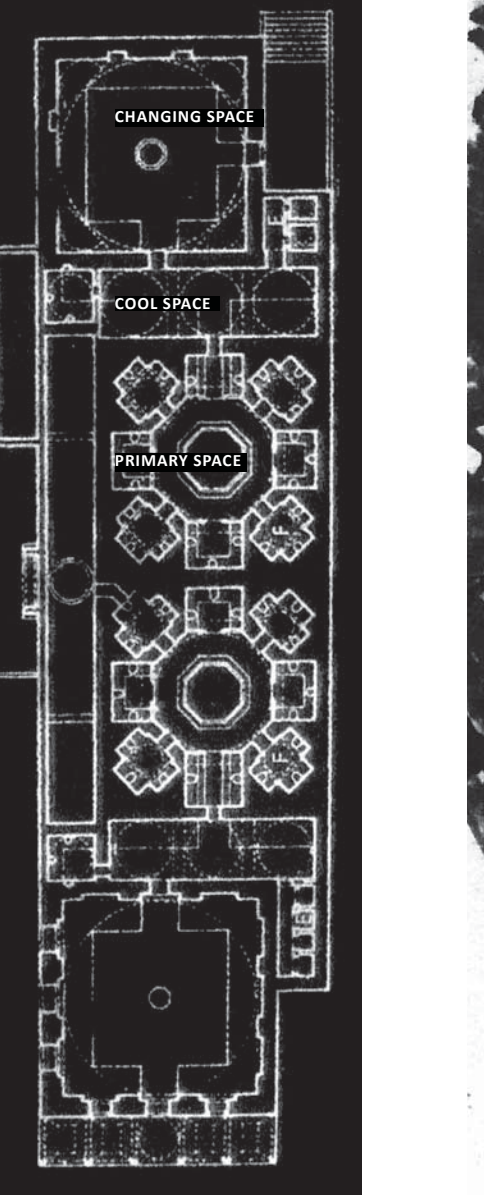

Plan of Haseki Hürrem Hamami, Istanbul. Photo.
The symmetrical building plan holds separate sections for men entering north and women entering south. Visitors move through a cool space before entering the hot central space.

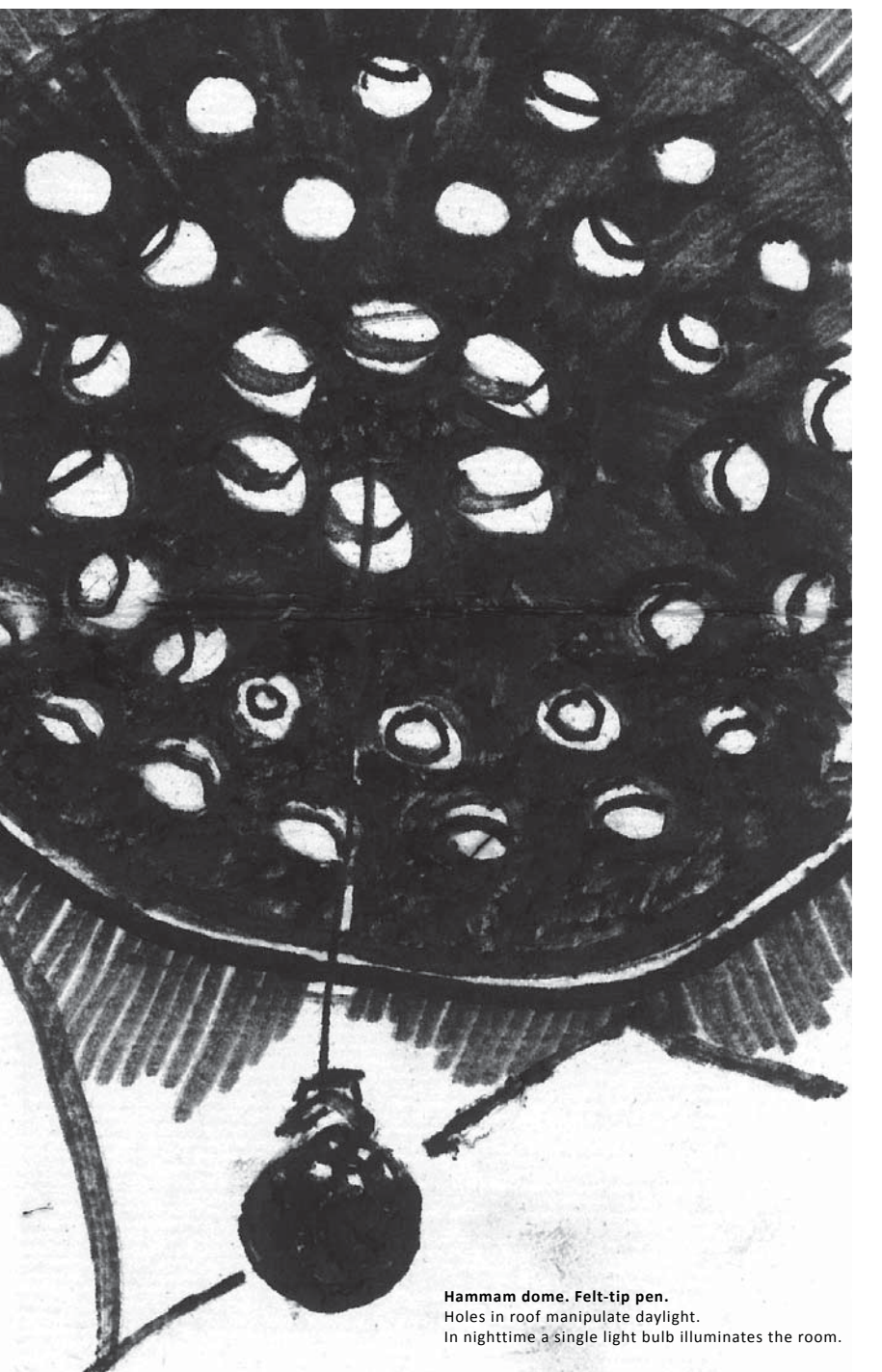

Hammam dome. Felt-tip pen.
Holes in roof manipulate daylight. In nighttime a single light bulb illuminates the room.

OTHER CASES

SZENCHENYI THERMAL BATHS. 1913

The huge Szechenyi thermal baths in central Budapest contains an impressive variety of functions, rooms and baths including outdoor swimming pools, restaurant, an array of indoor pools, saunas and steam baths and complete sections for respectively massage and medical treatment.

The indoor section with almost endless array of possibilities for cooling, heating, steaming or exercising the body made the greatest impression on this visitor. Each experience continuously in its own architectural realm.

THERMAL BATHS VALS, SWITZERLAND. 1996

The building is a place of experiencing. There are cool pools, hot water and rooms of buzzing music or vibrant echoes.

The south side of the building is used as sun deck with great mountain vistas - a contrast to the inside cave-like spaces.

ROMAN-BYZ. BATHS, GAMARA, ISRAEL. 400

This not fully excavated Roman bath is situated very much like the baths in Vals. It is built into a hill on the north side and has large openings to the south. This allows the sun to heat warm rooms additionally in daytime. And as in Vals visitors have vistas to the city and the surrounding landscape.

The bath layout contain entrance is to the west which leads into a changing room. To the south are a series of large spaces with different pools. The bath also contains a series of smaller rooms of more intense temperatures to the east.

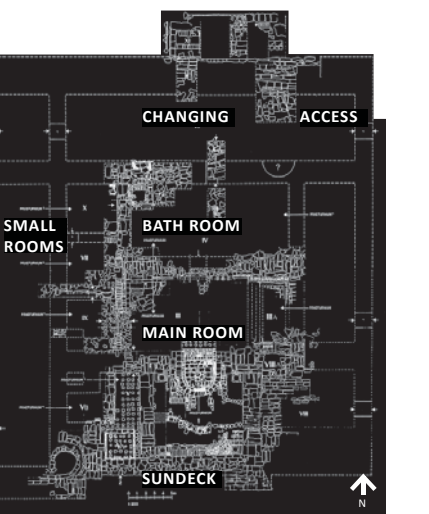
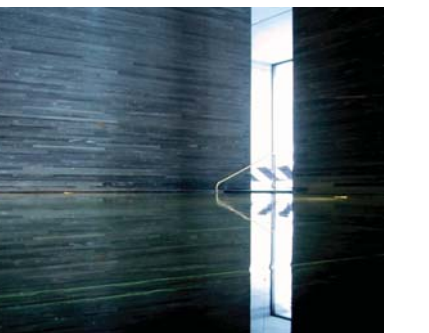

Top: Szechenyi Baths. Photo. [4]
Atmosphere of secluded courtyard.
Middle: Vals Baths. Photo. [5]
Atmosphere of cave like pool space.
Bottom: Gamara Baths. Archeological Plan. [6]
The large bath building contains a variety of spaces which are heated through an advanced underground system of ovens and pipes.

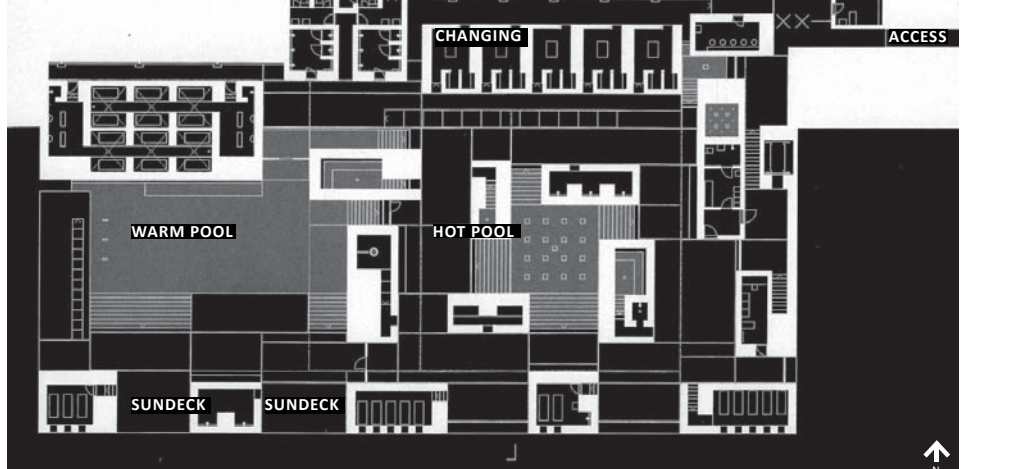
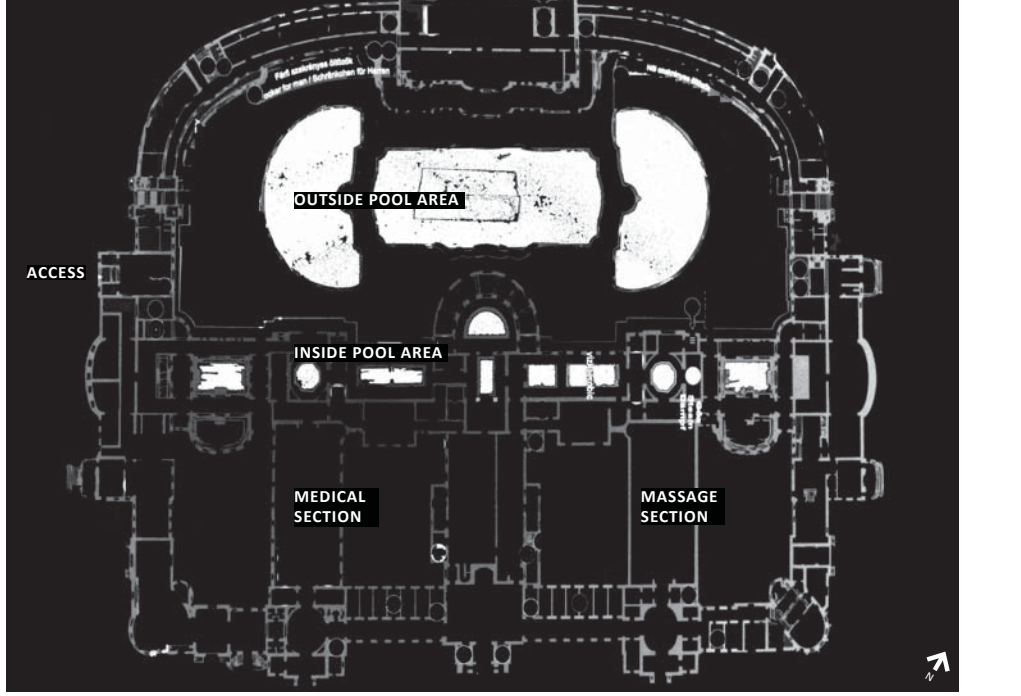

Top: Szechenyi Baths, Budapest. Plan.
The inside pool area holds an array of bath chambers.



Bottom: Thermal Bath, Vals. Plan. [7]
The north side is dug into the hill side, the south side exposed to sunlight and with mountain vistas.

INSPIRATION

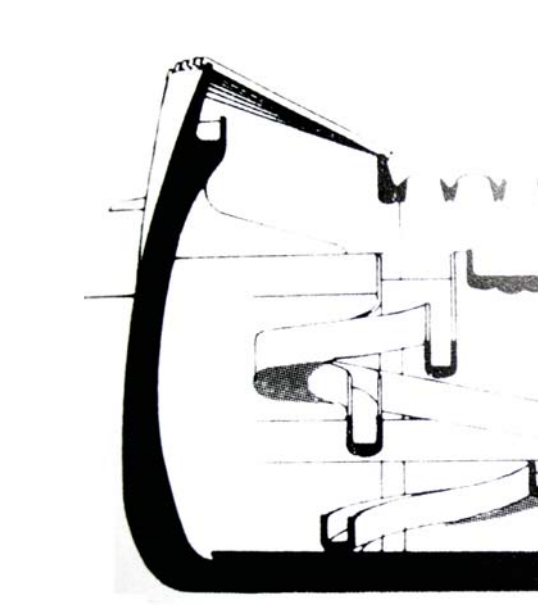

Top left: Imperial city, Beijing. Photo.
The spatial sequence, symmetry and asymmetry of space of Chinese imperial palaces and holy temples is a powerful source of inspiration.

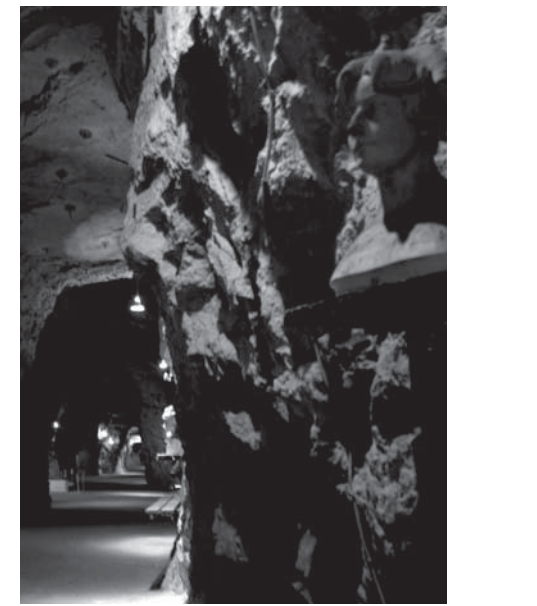

Top right: Tingbæk Chalk Mines. Photo.
Underground: The danger of collapse with resulting human casualties is in fresh memory for visitors experiencing the many exhibited sculptures.



Swimming pool Haraldslund. Basement. Photo.
An extensive infrastructure of technical equipment ensures fresh clean water and air to the above pool area. The extents of this secret underworld almost match the public world above.